

H8C



- H8C load cells are available in the capacities 1Klb~20Klb; 0.5t~10t.
- Alloy steel, sealed by adhesive inside, oil-proof, waterproof and anti-corrosion, suitable for all kinds of environments.
- Single shear beam, easy for installation.
- Suitable for electronic platform scales, hopper scales, and other electronic weighing devices.
- Safe and anti-explosive product, can be used in atrocious environment and hazardous areas.

Features

- Capacity: 1Klb~20Klb; 0.5t~10t
- High accuracy
- Alloy steel construction
- Low profile
- OIML Certificates No:R60/2000-CN-00.02
- PTB Approval No:D09-03.19 Revision 2
- NTEP Certificates No: CC07-012

Accessories

- HD-8-301 • HJ-8-201 • HJ-8-203 • HJ-8-208
- HJ-8-210 • HJ-8-213 • HJ-8-214 • HJ-8-216
- HJ-8-221 • HY-8-102 • HY-8-105 • HM-8-402



Specifications

Capacity	t	0.5/1/1.5/2/2.5/3/5/10				
		1/1.5/2/2.5/3/4/5/5KSE/7.5/10/20				
Accuracy		C2	C3	C4	A5M	B10M
Approvals	η_{max}		OIML R60 C3		III 5000 Multiple	IIIL 10000 Multiple
Maximum number of verification intervals	ν_{min}	2000	3000	4000	5000	10000
Minimum load cell verification interval	(%FS)	$E_{max}/5000$	$E_{max}/10000$	$E_{max}/14000$	$E_{max}/15000$	$E_{max}/10000$
Combined error	(%FS/30min)	$\leq \pm 0.030$	$\leq \pm 0.020$	$\leq \pm 0.018$	$\leq \pm 0.026$	$\leq \pm 0.050$
Creep	(%FS/10°C)	$\leq \pm 0.024$	$\leq \pm 0.016$	$\leq \pm 0.012$	$\leq \pm 0.017$	$\leq \pm 0.040$
Temperature effect on sensitivity	(%FS/10°C)	$\leq \pm 0.017$	$\leq \pm 0.011$	$\leq \pm 0.009$	$\leq \pm 0.013$	$\leq \pm 0.040$
Temperature effect on zero	(mv/v)	$\leq \pm 0.023$	$\leq \pm 0.015$	$\leq \pm 0.010$	$\leq \pm 0.014$	$\leq \pm 0.020$
Output sensitivity	(Ω)	2.0 \pm 0.002		3.0 \pm 0.003		
Input resistance	(Ω)	350 \pm 3.5				
Output resistance	(M Ω)	350 \pm 3.5				
Insulation resistance	(%FS)	\geq 5000(50VDC)				
Zero balance	(°C)	1.0				
Temperature, compensated	(°C)	-10~+40				
Temperature, operating	(V)	-35~+65				
Excitation, recommended	(V)	5~12(DC)				
Excitation, max	(%FS)	18(DC)				
Safe overload	(%FS)	150				
Ultimate overload		300				

Note: output sensitivity of S1 type is 2.0 \pm 0.002

Outline Dimension mm(inch)

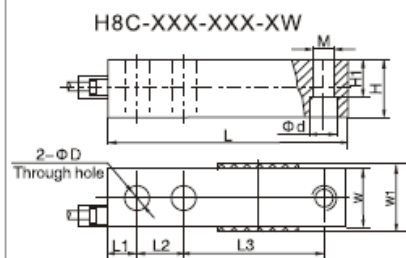

H8C-XXX-XXX-XB

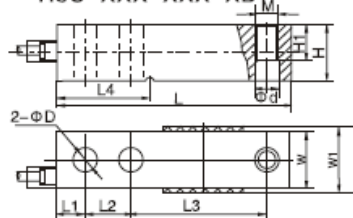

Dimension \ Capacity	L	L1	L2	L3	L4	H	H1	W	W1	D	d	M
0.5t - 2t	130 (5.12)	15.8 (0.62)	25.4 (1.0)	76.2 (3.0)	54.2 (2.13)	31.8 (1.25)	15.8 (0.62)	31.8 (1.25)	34 (1.34)	13.5 (0.53)	13.5 (0.53)	M12x1.75
1K-4K	130 (5.12)	15.8 (0.62)	25.4 (1.0)	76.2 (3)	54.2 (2.13)	31.8 (1.25)	15.8 (0.62)	31.8 (1.25)	34 (1.34)	13.5 (0.53)	13.5 (0.53)	1/2-20UNF
5KSE	130 (5.12)	15.8 (0.62)	25.4 (1.0)	76.2 (3)	54.2 (2.13)	31.8 (1.25)	15.8 (0.62)	31.8 (1.25)	34 (1.34)	13.5 (0.53)	13.5 (0.53)	1/2-20UNF
2.5t - 5t	171.5 (6.75)	19.1 (0.75)	38.1 (1.5)	95.3 (3.75)	77.2 (3.04)	38.1 (1.5)	18.8 (0.74)	38.1 (1.5)	40 (1.57)	19.8 (0.78)	19.8 (0.78)	M18x1.5
5K-10K	171.5 (6.75)	19.1 (0.75)	38.1 (1.5)	95.3 (3.75)	77.2 (3.04)	38.1 (1.5)	18.8 (0.74)	38.1 (1.5)	40 (1.57)	19.8 (0.78)	19.8 (0.78)	3/4-16UNF
10t	222.3 (8.75)	25.4 (1.0)	50.8 (2.0)	120.7 (4.75)	101.6 (4)	50.8 (2.0)	25.4 (1.0)	50.8 (2)	52.4 (2.06)	26.92 (1.06)	26 (1.02)	M24x2
20K	222.3 (8.75)	25.4 (1.0)	50.8 (2.0)	120.7 (4.75)	101.6 (4)	50.8 (2.0)	25.4 (1.0)	50.8 (2)	52.4 (2.06)	26.92 (1.06)	26 (1.02)	1-12UNF

Wiring:

Adopt shielded, 4 conductor cable: ϕ 5mm
Standard cable length: 4m(0.5t - 2t),
6m(2.5t - 10t, 1Kb - 20Klb)

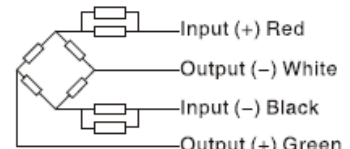

Note: This product has the stress groove, is not suitable for Australia market. For Australia users please choose H8C-XX-XX-XW.